



U-Pro<sup>TM</sup>  
HYBRID NFC

# U-Pro Dual Band NFC Snap-In TPMS Sensor

PREM-NFC

- Smart Phone Programmable
- Carries both 315 and 433 MHz Frequencies
- Valve Stem compatible with Parallel Type Base Design



Visit Product Page

## VIDEO: HOW TO PROGRAM THE SENSOR

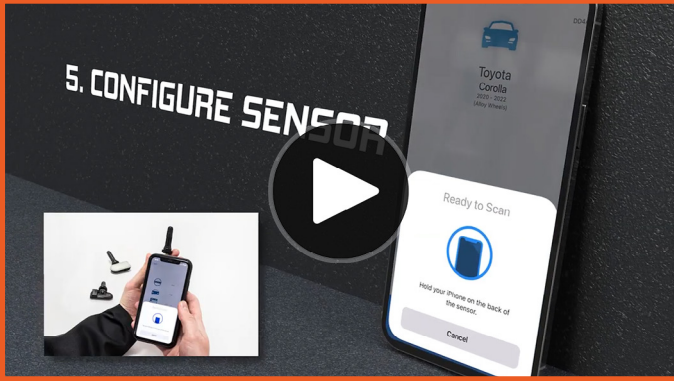

## PROGRAM BY PHONE OR BY TOOL



## PREM-H47

- Integrated OBDII Module
- Free Lifetime Updates
- Programs U-Pro Sensors
- Activates or Reads All Other TPMS Sensors

Visit Product Page

## FLYER



## COMPARISON

**Sensor Comparison Chart**

	U-Pro Hybrid NFC	U-Pro Hybrid 2.0
Code	PREM-NFC	PREM-ONE
Sensor Type	Universal	Universal
NFC Technology	Yes	No
High Low TPMS Compatibility*	Yes	Yes
Configurable	Yes	Yes
Programmable	Yes	Yes
Configure & Program via Smartphone and Free App	Yes	No
Compatible or Learning Diagnostic Scan	Yes	Yes
315 & 433 MHz Frequencies	Yes	Yes
Auto Location Technology	LOS, WAL, PAL, SAL & WAPSP	LOS, WAL, PAL & SAL
Interchangeable Valve Stem	Snap-In, Silver Clamp-In, Black Clamp-In & Straight Clamp-In	Snap-In, Silver Clamp-In, Black Clamp-In & Straight Clamp-In
Battery Type	Maxell	Maxell
Chip Type	EEPROM	EEPROM
Sensor Warranty	3 Years	3 Years

\*Some TPMS systems require a bleed of the pressure with the TPMS warning light on. In contrast, High Low TPMS systems display the pressure warning light on the dashboard when the pressure is low.

FOR VEHICLE COVERAGE, PLEASE VISIT PREMA-TPMS.COM

## INSTRUCTIONS

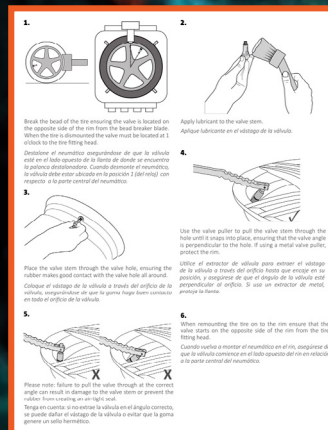

## ALSO AVAILABLE

## PREM-ONE

U-Pro Hybrid 2.0 Dual Band TPMS Sensor



Visit Product Page